

IPC2233-FN-SIR40-TU

2.0MP Starlight & Ultra WDR HD Network Vandal-Proof
Varifocal IR Semi Dome



Features

Excellent Image Quality

- 2.0 Megapixel 1/2.8" progressive scan CMOS sensor
- High definition and smooth picture, 1080p@30fps
- H.265 video codec, saves up to 50% bandwidth and storage
- 120dB Ultra WDR
- 2DNR / 3DNR / Auto Iris / HLC

Intelligent Functions

- Motion detection / Tampering / Entry Guard Area / Guard line / Defocus / Scene change / Enter guard area / Exit guard area / Object left / Object removal / Gathering / Audio surge

Vandal-Proof

- Above IK10 @ 50J collision energy

Integrated High Efficiency IR

- Industrial IR LED with long operational lifespan
- 40m IR distance
- Smart IR function

A Variety of Installation Modes

- Supports 90°, 180°, 270° image rotation
- Motorized varifocal lens

Abundant Functions and Features

- Micro SD card slot, supports Automatic Network Replenishment (ANR)
- Bi-directional audio / alarm in and out / video out / RS485
- 2 channel audio input simultaneously
- Up to 3 Multi-stream
- PoE
- IP67

Dimensions

Units:mm

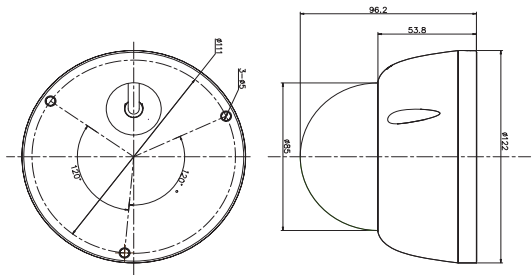

Specifications

IPC2233-FN-SIR40-TU	
Camera	IPC2233-FN-SIR40-TU
Image Sensor	1/2.8" progressive scan CMOS
Pixels	2.0 Megapixel
	Color: 0.005lux @ (F1.2, AGC ON)
	Color: 0.0035lux @ (F1.4, AGC ON)
	Color: 0.002lux @ (F1.6, AGC ON)
Min. Illumination	B/W: 0.0005lux @ (F1.2, AGC ON)
	B/W: 0.00035lux @ (F1.4, AGC ON)
	B/W: 0.0002lux @ (F1.6, AGC ON); 0lux with IR
Shutter Speed	1 - 1/30,000s
Day / Night	Auto (ICR) / Color / B/W
Wide Dynamic Range	Ultra WDR, >=120dB
S/N Ratio	>50dB
White Balance	Auto / Manual
Gain Control	Auto / Manual
Backlight Compensation	Off / BLC / WDR / HLC
Lens	
Mount Type	Φ14
Auto Iris	DC drive
Focal Length	-Z2712: 2.7-12mm motorized varifocal lens
Focus Control	Manual / Semi-Automatic / Auto
Angle of View	-Z2712: 106° - 33°
Adjustment Range	Pan: -120° - +120° / Tilt: 0° - 65° / Rotation: -90° - +90°
Infrared	
IR Distance	40m
IR Intensity	Smart IR
Video	
Compression	H265 + / H.265 / H.264 / MJPEG
Image Resolution	Main stream: 1080p
	Secondary stream: D1
	Triple stream: 1280 x 720@30fps
Frame Rate	Main stream: 1080p@30fps
	Secondary stream: D1@30fps
Bitrate	32kbps - 16Mbps
Bitrate Control	VBR / CBR
Multi-stream	Supported
Caption	Date and time / Alarm / Customized / Min. 50 characters
Privacy Masking	Up to 4 zones
Motion Detection	Up to 4 zones
Video Freeze	Supported
ROI	Supported
Digital Noise Reduction	2DNR, 3DNR
Digital Defog	Supported
Image Flip	Flip / Mirror / Rotation at 90°, 180°, 270°
Corridor Mode	Supported
EIS	Supported
Distortion Connection	Supported
Audio	
Compression	G.711a / G.711u / ADPCM / G.722 / AAC-LC / G.722.1c / G.726
Bitrate	8kbps - 64kbps
Audio Function	Bi-directional audio / AEC / Mixed audio recording / Dumb / Mute
Network	
Network Protocols	TCP/IP, UDP, HTTP, HTTPS, DHCP, DNS/DDNS, RTP/RTCP, RTSP, PPPoE, FTP, VSIP, UPnP, 802.1x, NAT, QoS, SSH, NTP, SNMP, IGMP, SMTP, Unicast, Multicast, IPv4, IPv6 (optional)
Unicast	Min. 5 Users
Multicast	Unlimited Users
User Interface	IPC Control (IE, Firefox, Chrome)
Max. User Access	Max. 10 Users (Includes 2 internal)
Application Programming	ONVIF (Profile S, Profile G), GB/T 28181-2011, API, CGI
Automatic Network Replenishment (ANR)	Supported
Dual IP	Supported
Network Test	Supported
Alarm	
Alarm Triggers	Alarm input / Network disconnect / Disk full / Disk error
Intelligent	Motion detection / Tampering / Entry Guard Area / Guard line / Defocus / Scene change / Enter guard area / Exit guard area / Object left / Object removal / Gathering / Audio surge
Alarm Events	Alarm report / Recording / Text overlay / Snapshot / External output / Email notice / Acoustic alarm
Interfaces	
Ethernet	10/100M, RJ45 interface
Audio In / Out	2 x Line In / 1 x Line out
Control	1 x RS485
Alarm In / Out	1 x Input / 1 x Output
Video Out	1 x BNC, 1.0V [p-p] / 75Ω
Memory Slot	Micro SD card slot, supports up to 128GB
Environmental	
Operating Temperature	-40°C - 70°C / -40°F - 158°F
Operating Humidity	10% - 95%
Protection Level	IK10+ @50J, IP67
Electrical	
Power	DC12V ± 10% / PoE (IEEE802.3af)
Power Consumption	Max. 11W
Mechanical	
Weight	0.71 kg / 1.57lb (Gross Weight)
Dimensions	Φ122x 96.13mm / Φ4.8" x 3.78"
Standard	CE, FCC, EMC, LVD